

CURVE	LENGTH	RADIUS
C1	88.42'	473.00'

N/F
 Douglas C. and An
 Deed Book 1111,
 Plan Book NN, Page
 Tax Parcel P2

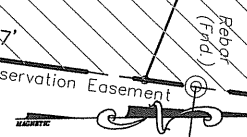

Project No. 204005
 Date 4/15/06
 CAD File 204005plt
 Revision Date: ---
 Scale: 1" = 100'
 Sheet No. 1 of 1

**PROPERTY PLAT
 FOR
 LOT #9
 SIDDONSBURG ESTATES**
 Located In
 Fairview Township, York County, Pennsylvania

MELLOTT ENGINEERING, INC.
 Civil Engineering • Land Planning & Development • Water Resources
 7500 Devonshire Heights Road • Hummelstown, PA 17036
 717-566-6533